

### VUL Series 片式铝电解电容器长寿命品

#### Long Life Aluminum Electrolytic Capacitor of V-chip Type

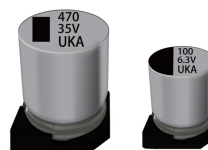

- +105°C,寿命为 5000 小时, 等同+55°C时寿命为 160000 小时
- 适用于回流焊 ● 适用于高密度表面组装
- Load life of 5000 hours at 105°C, equal to 160000 hours at 55°C
- Reflow soldering is available ● Available for high density surface mounting



#### ■主要技术性能 Specifications

使用温度范围 Operating Temperature Range	-40~+105°C									
额定电压范围 Rated Voltage Range	6.3~100V DC									
标称电容量允许偏差 Capacitance Tolerance	±20% (120Hz, 20°C)									
漏电流(20°C) Leakage Current	I ≤ 0.01CV (μA) 或 3 μA 取较大者, 2 分钟									
	I ≤ 0.01CV or 3 μA whichever is greater (after 2 minutes)									
I=Leakage Current(μA), C=Capacitance(μF), V=Rated DC Working Voltage(V)										
损耗角正切值(120Hz 20°C) Dissipation Factor	WV	6.3	10	16	25	35	50	63	80	100
	tg δ	0.28	0.24	0.20	0.16	0.13	0.12	0.09	0.08	0.07
温度特性 (120Hz) Temperature Characteristics Impedance Ratio (120Hz)	WV	6.3	10	16	25	35	50	63	80	100
	Z <sub>-25°C</sub> /Z <sub>+20°C</sub>	4	3	2	2	2	2	2	2	2
	Z <sub>-40°C</sub> /Z <sub>+20°C</sub>	10	7	5	3	3	3	3	3	3
耐久性 Load Life	+105°C施加额定电压 5000 小时, 恢复 16 小时后,电容器应满足要求									
	After applying rated voltage for 5000 hours at +105°C and then resumed 16 hours. The capacitor shall meet the following limits.									
	电容量变化率 Capacitance Change	≤ ±30%初始测量值								
	漏电流值 Leakage	≤ 规定值								
损耗角正切值 Dissipation Factor	≤ 3 倍规定值									
高温贮存 Shelf Life (105°C)	试验时间: 1000 小时, 其他项目与耐久性相同。电压应用处理: 根据 JIS C5101-4 4.1									
Test time : 1000hours ; other items are same as the endurance. Voltage application treatment : According to JIS C5101-4 4.1										
额定纹波电流频率系数 Coefficient of Frequency for Rated Ripple Current	Frequency	50Hz	120Hz	1KHz	≥10KHz					
	Capacitor 6.3~100V	0.70	1.00	1.30	1.40					

# VUL Series

## 外形图 Outline

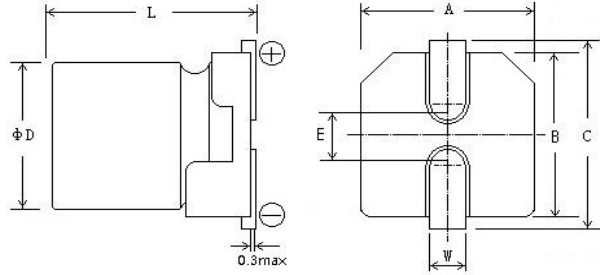

Drawing

单位 Unit : mm

Size	6.3×6.0	6.3×7.7	8×10.2	10×10.2	12.5×13.5	12.5×16	16×16.5	18×16.5
A/B±0.2	6.6	6.6	8.3	10.3	13.0	13.0	17.0	19.0
D±0.5	6.3	6.3	8.0	10	12.5	12.5	16.0	18.0
E±0.2	2.2	2.2	3.1	4.5	5.2	5.2	6.5	6.5
L	5.4	7.7	10.2	10.2	13.5	16.0	16.5	16.5
C±0.2	7.3	7.3	9.0	11.0	13.8	13.8	18	20
W	0.5~0.9		0.8~1.1		1.1~1.4			

## 规格壳号、最大允许纹波电流 Standard sizes & Maximum permissible ripple current

wv Cap(μF)	6.3V		10V		16V		25V		35V	
	ΦD×L (mm)	I (mA)	ΦD×L (mm)	I (mA)	ΦD×L (mm)	I (mA)	ΦD×L (mm)	I (mA)	ΦD×L (mm)	I (mA)
22							6.3×6.0	44	6.3×6.0	44
33					6.3×6.0	48	6.3×6.0	50	6.3×7.7	57
47			6.3×6.0	50	6.3×6.0	50	6.3×7.7	65	8×10.2	92
100	6.3×6.0	71	6.3×7.7	81	6.3×7.7	81	8×10.2	130	10×10.2	151
220	6.3×7.7	101	8×10.2	160	8×10.2	160	10×10.2	290	10×10.2	220
330	8×10.2	230	10×10.2	290	10×10.2	290	10×10.2	320	12.5×13.5	320
470	8×10.2	230	10×10.2	320	10×10.2	340			12.5×16	410
1000	10×10.2	320							16×16.5	690
1500									18×16.5	900
wv Cap(μF)	50V		63V		80V		100V			
	ΦD×L (mm)	I (mA)	ΦD×L (mm)	I (mA)	ΦD×L (mm)	I (mA)	ΦD×L (mm)	I (mA)		
10	6.3×6.0	35								
22	6.3×7.7	58								
33	8×10.2	91								
47	8×10.2	100								
68							12.5×13.5	180		
100	10×10.2	160			12.5×13.5	220	12.5×16	240		
150			12.5×13.5	240	12.5×16	290	16×16.5	340		
220	12.5×13.5	280	12.5×16	320	16×16.5	410	16×16.5	410		
330	12.5×16	360	16×16.5	450	16×16.5	510	18×16.5	540		
470	16×16.5	510	16×16.5	540	18×16.5	650				
1000	18×16.5	780								

I~额定纹波电流 Rated ripple current: (mA, 105°C, 120Hz)